

## Address Sign Installation Instructions

MSYD (Metal Signs and Your Designs) custom personalized address signs add a unique touch to your home or business. The following information will guide you thru the steps to properly install and display your new personalized address sign.

### Fastener Type

The fastener type is determined by the surface to which you are attaching your sign or rack. On the exterior of a home or business, the most common mounting surface is stucco. Our signs are provided with hardware for this option. For attachment to other surfaces such as wood, masonry or metal, please visit your local hardware store. The mounting holes in our address signs are .210 in diameter, which will accommodate a #8 screw. **It is important to purchase the correct hardware type for your application!**

### Mounting Options

Our address signs come with thru holes around the perimeter of the sign for direct attachment to the structure of your choice. Our standard mounting kit comes with #8 stainless steel screws and plastic stucco wall anchors (quantity depends on size of sign). We also offer an optional mounting kit, that contains a black powder coated aluminum mounting plate with #8 studs, 1/2" tall stainless-steel spacers and #8 stainless-steel decorative nuts. This optional mounting kit provides you with a black background and a 1/2" stand-off from your mounting surface.

### Required Tools

- Drill
- 1/4" Masonry Drill Bit (for stucco installation)
- Level
- Phillips Screw Driver
- Pencil
- 5/16 Wrench (required for optional mounting kit)
- Additional tools maybe required for mounting surfaces other than drywall

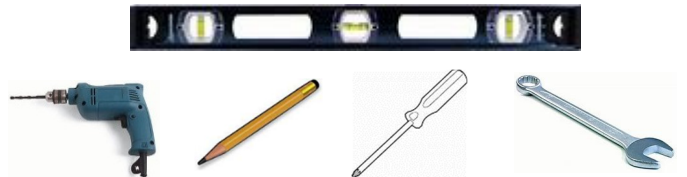

### Installation Instructions

#### 1. Locate, level and mark hole locations

Once you've decided on the perfect spot, mark the location of the mounting holes. For a standard installation (address sign only), use the sign as a template to mark the location for all mounting holes. Hold the sign against the structure, level the sign, and then use a pencil to mark the hole locations.



For the optional mounting kit installation, use the black powder coated mounting plate as a template to mark the location for the mounting holes. Hold the mounting plate against the structure, level the plate, and then use a pencil to mark the hole locations.

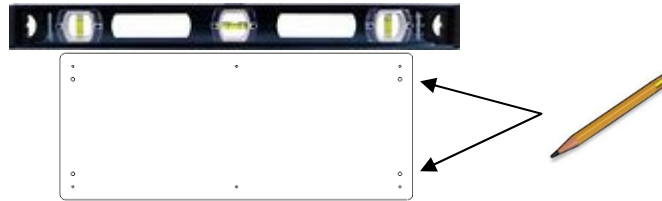

## 2. Drill the required hole size based on the hardware requirements

The hole locations should be visible after marking. When mounting the address sign to stucco, drill a 1/4" hole at the center of the marked hole locations. For other surface types use the appropriate hardware and tools required for attachment.

## 3. Insert the stucco anchors

Insert the stucco anchors into the 1/4" drilled holes. Use a hammer to lightly tap in the stucco anchors. For other surface types, use the manufacturer's instructions.

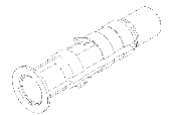

## 4. Install the address sign or mounting plate

Locate the address sign or mounting plate holes over the stucco anchor holes. Using the #8 screws, attach the address sign or mounting plate to the structure with a Phillips screwdriver.

If installing the optional mounting kit, continue with step 5.

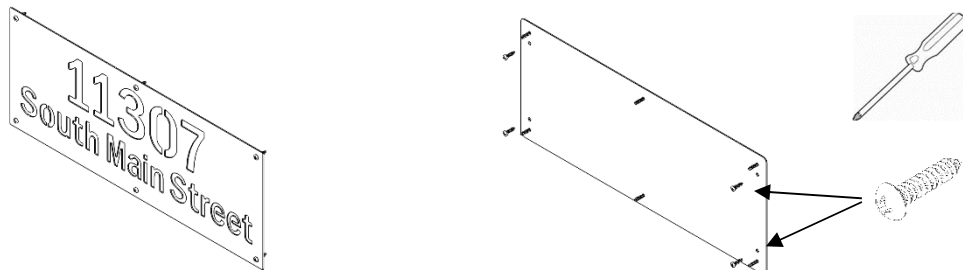

## 5. Mount address sign to the mounting plate

Install the 1/2" long stainless-steel spacers over each of the studs on the mounting plate. Locate the sign on top of the spacers and then add the decorative nuts to hold the sign in place. Use a 5/16" wrench to gently tighten the decorative nuts. Congratulations, you are finished with the installation!

