



**Where Custom Products are  
Personalized by You!**

## **Frame System Installation Instructions**

MSYD (Metal Signs and Your Designs) custom personalized frame system add a unique touch to a home or business. The following information will guide you thru the steps to properly install and display your new personalized frame system.

### **Fastener Type**

The fastener type is determined by the surface to which you are attaching your sign or rack. On the interior of a home or business, the most common mounting surface is drywall. Our frame systems are provided with hardware for this option. For attachment to other surfaces such as wood, stucco, masonry or metal, please visit your local hardware store. The mounting holes are .210 in diameter, which will accommodate a #8 screw. **It is important to purchase the correct hardware type for your application!**

### **Mounting Options**

Our frame systems come with slotted holes in the mounting plates located on the back of the frame system for the direct attachment to the structure of your choice. Our mounting kit comes with #8 stainless steel screws and drywall anchors (quantity depends on size of sign).

### **Required Tools**

- Drill
- 1/4" Drill Bit (for drywall installation)
- Level
- Phillips Screw Driver
- Pencil
- Additional tools maybe required for mounting surfaces other than drywall

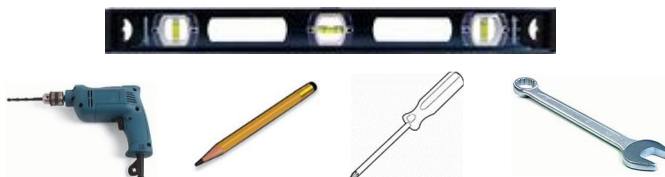

## **Installation Instructions**

### **1. Remove all tiles from the frame system**

Pull and rotate the spring-loaded plate located at the end of the frame. Plates without grooves can be rotated. Plates with grooves are fixed and can't be rotated. Once you have rotated the plate to expose the grooves channels, gently slide all tiles out of the frame.



## 2. Locate, level and mark hole locations

Once you've decided on the perfect spot, mark the location of the mounting holes. Use the frame system as a template to mark the location of the top mounting holes. Hold the frame system against the structure, level the sign, and then use a pencil to mark the hole locations.

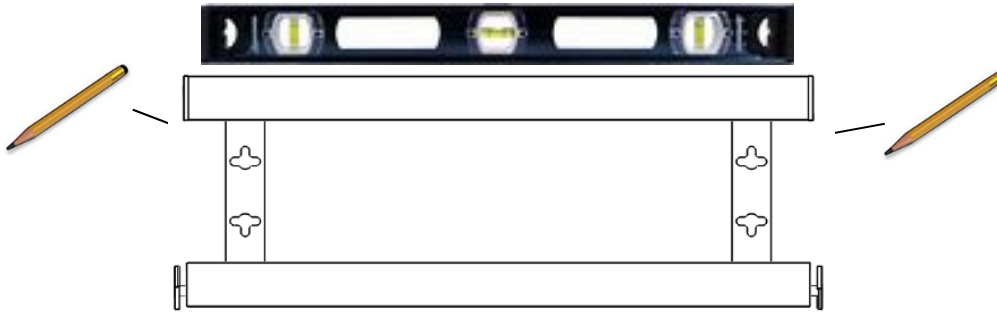

## 3. Drill the required hole size based on the hardware requirements

Remove the frame system from the surface. The hole locations should be visible after marking. When mounting the frame system to drywall, drill a  $\frac{1}{4}$ " hole at the center of the marked hole locations. For other surface types use the appropriate hardware and tools required for attachment.

## 4. Insert the drywall anchors and screws

Insert the drywall anchors into the  $\frac{1}{4}$ " drilled holes. Use a hammer to lightly tap in the drywall anchors. Install the #8 screws into the drywall anchors. Leave an approximate  $\frac{1}{8}$ " gap between the bottom of the screw head and the drywall anchor. For other surface types, use the manufacturer's instructions.

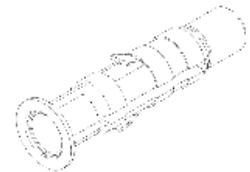

## 5. Install the frame system

Locate the frame system mounting holes over the screws and slide into place. Using a Phillips screwdriver, lightly tighten the #8 screws so they are snug against the frame.

## 6. Insert tiles into the frame system

Insert the front and back tiles in the desired configuration. Once all tiles are installed, pull and rotate the spring-loaded plate located at the end of the frame to lock the tiles in place.

Your installation is finished, enjoy your new personalized product!